

Parts List			
ITEM	QTY	PART NUMBER	DESCRIPTION
1	1	050DECAL	BANJO LOGO DECAL
2	4	V20017	3/8-16 X 4" HHCS
3	4	V20018	3/8" LOCKWASHER
4	4	V20019	3/8" HEX NUT
5	1	V20020	2" HANDLE BOLT
6	1	V20021	HANDLE WASHER
7	1	V20151M	VALVE STEM W/ BEARING
8	1	V20159	2" STEM BUSHING
9	1	V20163	AS568A -116 O-RING, FKM, BROWN
10	2	V20264	AS568A -151 O-RING, FKM, BROWN
11	2	V20267	1 1/4" NPT ENDPLATE, MACHINED
12	1	V20344B	1 1/4" NPT BL VALVE BODY, MACHINED
13	1	V20353C	1 1/8" CAPLUG
14	1	V20353TB	2" BOTTOM LOAD T-HANDLE
15	1	V20355B	2" 3-WAY BL BALL, TUMBLED
16	2	VE20258A	2" VE SEAT TFM
17	1	VL1018	300 PSI DECAL (N/S)

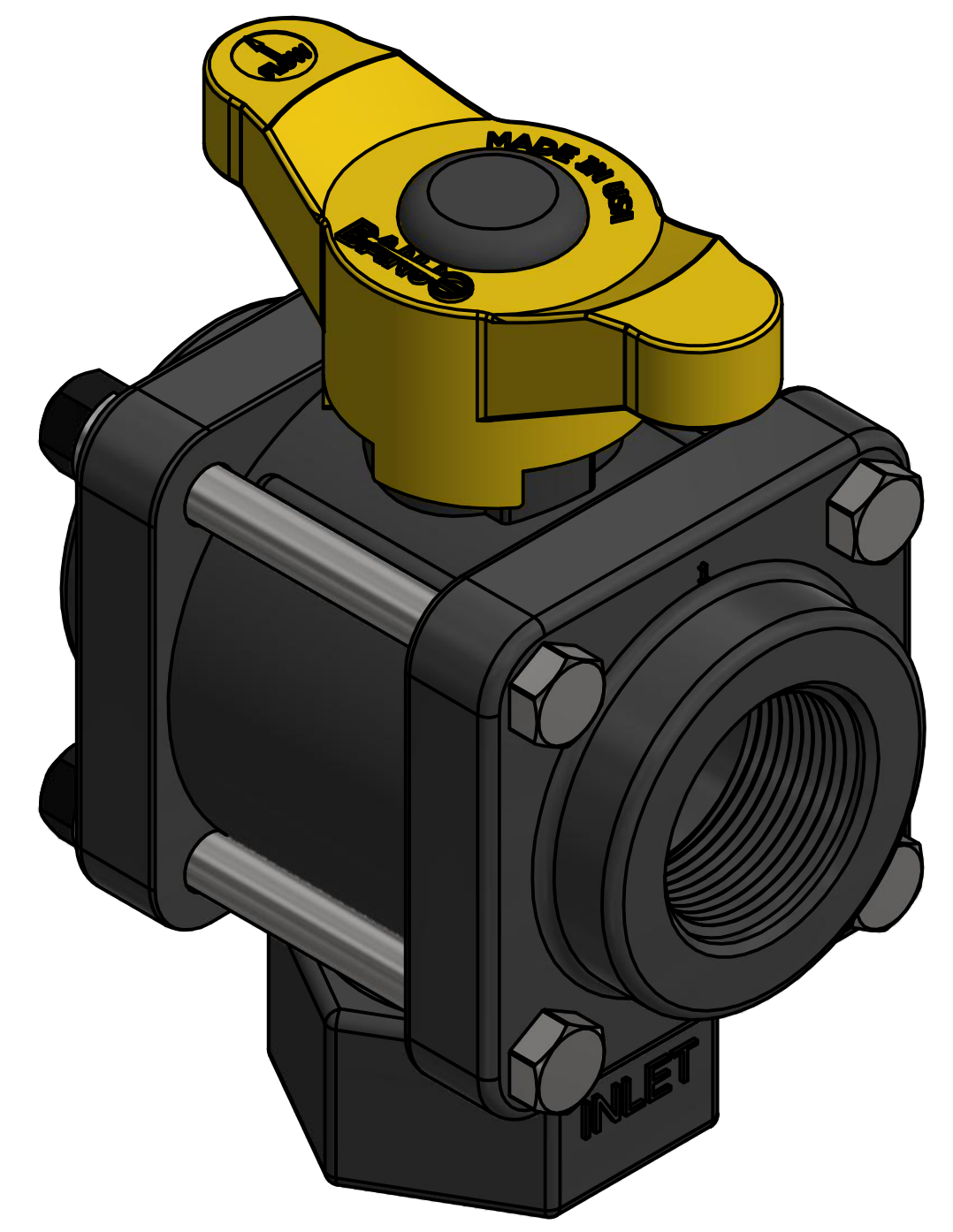
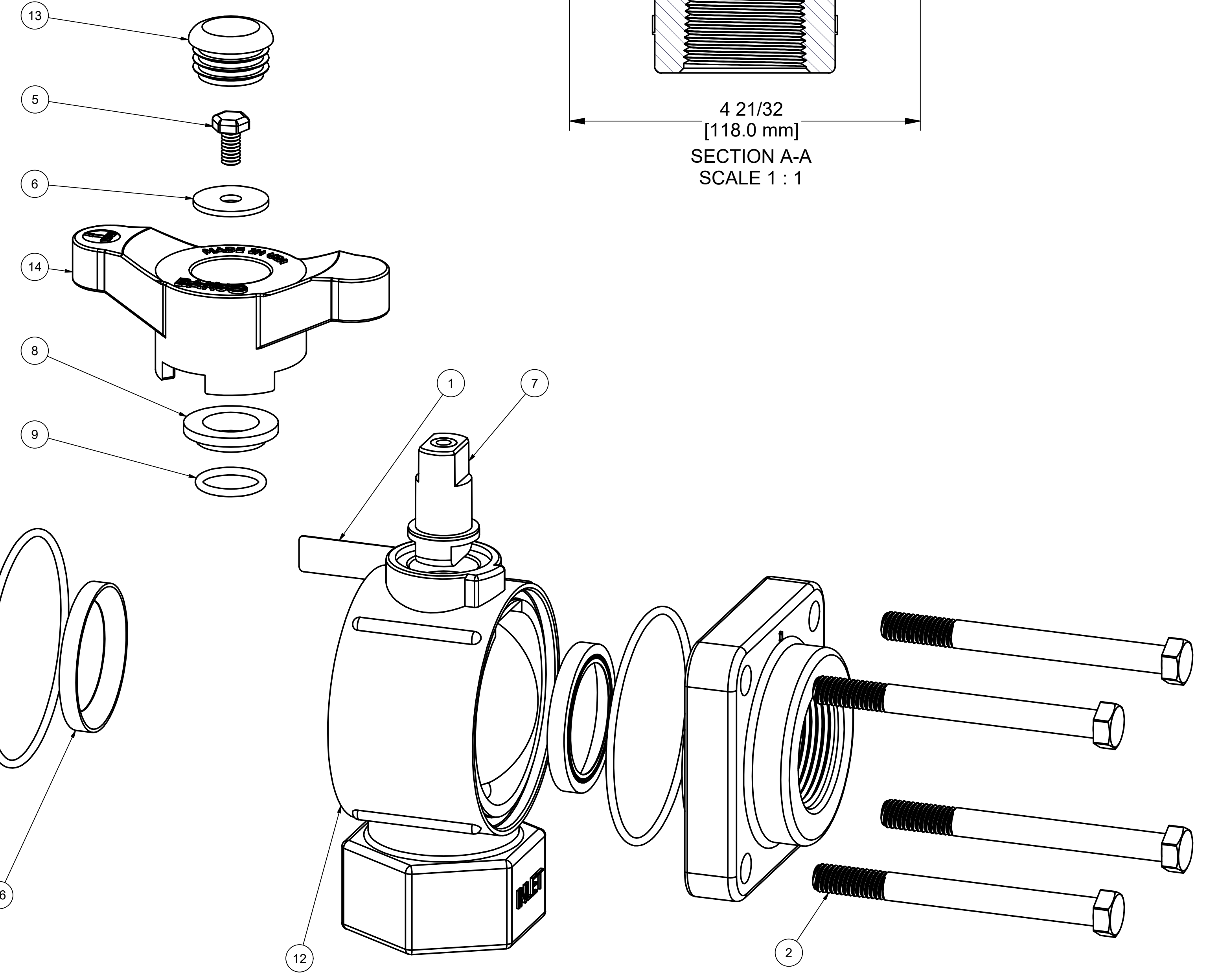

THIS DRAWING AND ALL INFORMATION CONTAINED THEREON ARE THE EXCLUSIVE PROPERTY OF BANJO CORPORATION.

UNLESS SPECIFICALLY NOTED, THIS DRAWING AND ITEMS SHOWN ON THIS DRAWING ARE SUBJECT TO CHANGE AT ANY TIME.

BANJO CORPORATION
 150 BANJO DRIVE, CRAWFORDSVILLE, IN 47933
 WEB SITE: WWW.BANJO.CORP.COM
 E-MAIL: BANJOSALES@IDEXCORP.COM

DESCRIPTION
1 1/4" BOTTOM LOAD 3-WAY VALVE

PART NUMBER
V125BL